

With its highly pitched roofline, the modern lighting design of the Peak outdoor wall sconce light is reminiscent of a clapboard shingle. The angular LED downlight gently grazes the surface of the extended back plate. Cleverly hidden hardware ensures a clean look.

Outstanding protection against the elements:

- Powder coat finishes
- Stainless Steel mounting hardware
- Impact-resistant, UV stabilized frosted acrylic lensing

SPECIFICATIONS

DELIVERED LUMENS	295
WATTS	14.5
VOLTAGE	120V
DIMMING	ELV
LIGHT DISTRIBUTION	Symmetric
MOUNTING OPTIONS	Wall
CCT	Warm Color Dimming (3000K - 2200K)
CRI	90
COLOR BINNING	3-Step
BUG RATING	N/A
DARK SKY	Compliant
WET LISTED	IP65
GENERAL LISTING	ETL
CALIFORNIA TITLE 24	Can be used to comply with CEC 2016 Title 24 Part 6 for outdoor use. Registration with CEC Appliance Database not required.
START TEMP	-30°C
FIELD SERVICEABLE LED	Yes
CONSTRUCTION	Aluminum
HARDWARE	Stainless Steel
FINISH	Powder Coat
LED LIFETIME	L70; 70,000 hours
WARRANTY*	5 years
WEIGHT	3.5 lbs.

* Visit techlighting.com for specific warranty limitations and details.



PEAK
shown in bronze



PEAK
shown in silver

ORDERING INFORMATION

700WSPEAK	FINISH	LAMP
Z	BRONZE	LEDLW LED 90CRI, 3000K-2200K, 120V
I	SILVER	

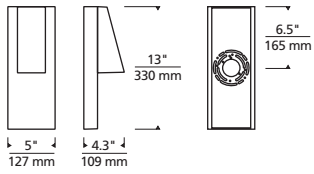

Peak

PHOTOMETRICS*

*For latest photometrics, please visit www.techlighting.com/OUTDOOR

PEAK

Total Lumen Output:	295
Total Power:	14.5
Luminaire Efficacy:	20
Color Temp:	Warm Color Dimming (3000K - 2200K)
CRI:	90
BUG Rating:	N/A

PROJECT INFO

FIXTURE TYPE & QUANTITY	JOB NAME & INFO	NOTES
<hr/>	<hr/>	<hr/>
<hr/>	<hr/>	<hr/>